



# 7094/H3 PROOF Mercury EL

Certified self-loading stretcher - high version



## FEATURES

Mercury EL is the newest entry in Me.Ber's range of ambulance cots. Sharing many features from other Mercury models, the EL is a naturally highly reliable and versatile cot. This model represents the entry level for the Mercury line.

Unlike most Mercury models, the EL does not feature a foldable front trolley and nor 4 swivel castors. However, this version is multilevel and serves as a **perfect solution** when a high standard of quality must be met while keeping things **easy and accessible**.

### Safe-Frame Technology:

The frame of an ambulance cot must withstand intense mechanical stress: this is why Mercury features a single-piece frame, in line with Me.Ber.'s Same Frame building philosophy.

Thanks to this expedient, the structure of the cot is extremely safe and robust through time.



Device certified according to the European harmonized safety standards UNI EN 1865 - UNI EN 1789.

\*All Pictures shown are for **illustration purpose** only.

MAIN FEATURES

Type	
Size	Adults
Usage	Transport
10G Certification	
Wheel type	2 Rotating Wheels + 2 Big Fixed Wheels
Lying surface	With Trendelenburg
Max height (cm)	99
Max loading height (cm)	71
Min loading height (cm)	69
Folded height (cm)	31
Width (cm)	57
Length (cm)	197
Weight (kg)	47,7
Loading capacity (kg)	250
Material	Painted steel ABS HDPE (High-density polyethylene)
Multilevel	
Intermediate height (cm)	75

SEE ALSO



**Mercury EL 7092 PROOF**  
Certified self-loading stretcher



**Mercury 7070/4RG PROOF**  
Stainless steel variable height  
stretcher certified with 4 rotating  
wheels



**Mercury 7072/4RG PROOF**  
Certified stainless steel variable  
height stretcher high version with 4  
rotating wheels



**Mercury Lite 7080/4RG Proof**  
Ambulance cot in aluminium with  
variable height and four swivel  
castors



**Mercury Lite 7082/4RG Proof**  
Certified aluminium variable height  
stretcher high version with 4  
rotating wheels



**Mercury Cinque 7075/4RG PROOF**  
Certified 5 levels self-loading  
stretcher with 4 swivel wheels



**Mercury Cinque 7077/4RG PROOF**  
Certified 5 levels self-loading  
stretcher with 4 swivel wheels -  
high version



**Mercury Lite Cinque 7095/4RG  
Proof**  
Certified aluminium 5 levels self-  
loading stretcher with 4 swivel  
wheels



**Mercury Lite Cinque 7097/4RG  
Proof**  
Certified aluminium 5 levels self-  
loading stretcher with 4 swivel  
wheels - high version

## ACCESSORIES



**12025**

Black multi usage object holder for automatic loading stretcher



**12154**

"BEAR PODS" Bariatric containment system for self-loading stretchers



**12018N**

Telescopic foldable phleboclysis stand for self loading stretchers



**939**

Instrument support for stretchers



**12080**

"MPB" wide bariatric platform for self-loading stretchers Frog Mercury and Gecko complete of belts with reel and fixing for stretcher



**12080-001**

Monting kit for bariatric platform on self loading stretcher



**12084-001**

Cover for bariatric wings set



**12070/BG**

"COVER OX 2-3 BG"- professional cylinder holder for 2 and 3 lt oxygen bottles



**12070/BR**

COVER OX 2-3 BR professional cylinder holder with belt and orange MeBer logo for 2 and 3 lt oxygen bottles



**12072/BG**

"COVER OX 5 BG"- professional cylinder holder for 5 lt oxygen bottles



**12072/BR**

"COVER OX 5 BR"- professional cylinder holder for 5 lt oxygen bottles



**955 PROOF**

EN 1789 fixing system for Proof roll-in stretchers



**12106**

Mattress for AIR-COM stretchers - Anti-bedsore mattress with alternate segments



**7013/N**

3 pcs. Skay fire-proof electrowelded mattress



**938**

Oximeb oxygen cylinder holder



**608/A-MEB**

2 pieces orange belt with metallic hook and MeBer band (L. 155 cm)



**608/N-MEB**

2 pieces black belt with metallic hook and MeBer band (L. 155 cm)



**612/AN-2/MEB**

Adjustable thoracic abdominal belt



**612/N-2/MEB**

Adjustable thoracic abdominal belt

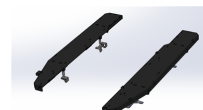

**12200**

Bariatric wings set for Mercury self-loading stretchers complete with mattresses, belts with reel and assembly kit

orange/black with MeBer band and  
4 points fastening for self loading  
stretchers and sedan chairs

black with MeBer band with 4  
points fastening for self loading  
stretchers and sedan chairs



**707**

Red 6-handle fireproof cover with  
Me.Ber tape for self-loading  
stretcher

## STANDARD ACCESSORIES



**608/N-MEB**

2 pieces black belt with metallic  
hook and MeBer band (L. 155 cm)



**612/N-2/MEB**

Adjustable thoracic abdominal belt  
black with MeBer band with 4  
points fastening for self loading  
stretchers and sedan chairs



**7013/N**

3 pcs. Skay fire-proof electrowelded  
mattress