



## 1515 PROOF Fixed stretcher

---

Fixed stretcher with rigid bed



---

### FEATURES

Fixed stretcher built in anodized aluminium with painted rigid back rest and bed. Resistant and easy to clean. Trendelenburg and Fowler positions. Suitable for our ambulance trolleys (TITANUS) or as a hand-carried stretcher.

Available in the version with anti-vibration (no Trendelenburg and no Fowler)

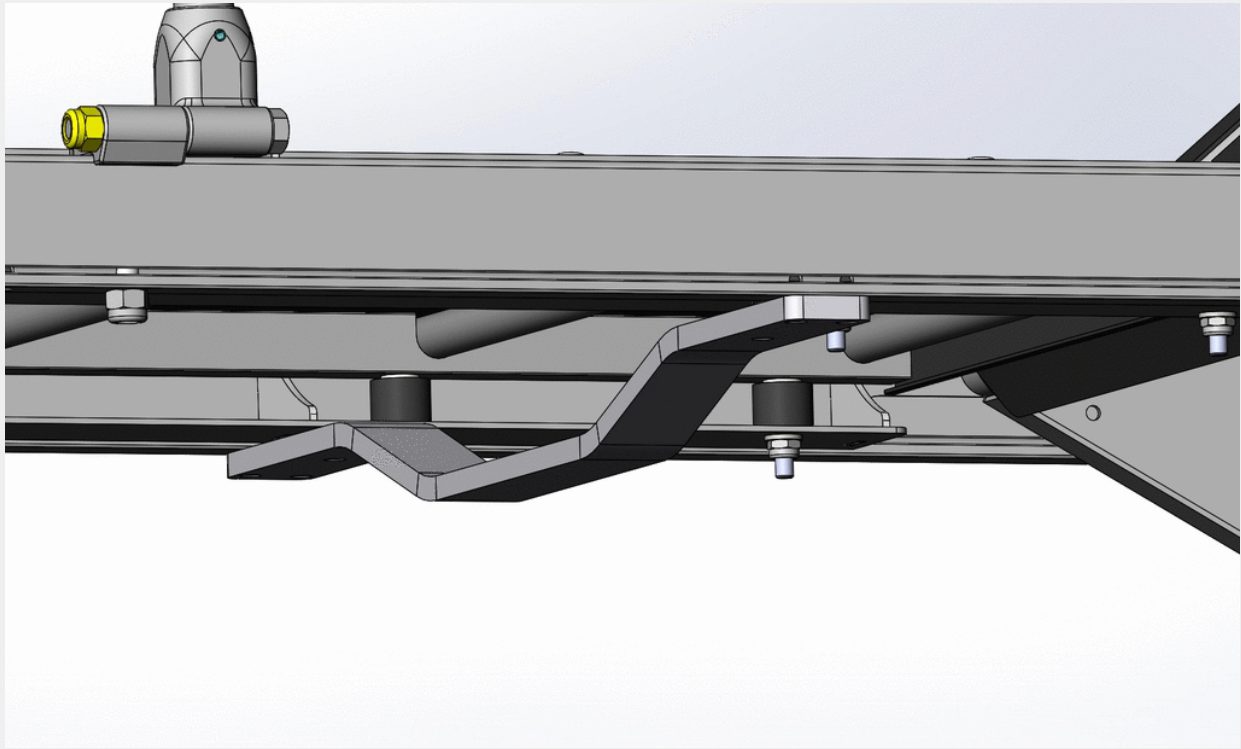

The vibration-absorbing element of the stretcher is made up of six natural rubber anti-vibration mounts which contribute to the reduction of any stress on the stretcher both when used on the trolley and especially during transport by ambulance.

- 4 extractable and adjustable handles
- 4 wheels diam. 100mm
- adjustable backrest 75 degrees
- Supplied with 2 belts (art. 608-A/MEB or 608-N/MEB), n. 3 belts (art. 605C), n.1 belt (art. 612/AN-2/MEB or 612/N-2/MEB) and 1 mattress (art. 7014)
- Foldable side rails

*Device certified according to the  
European harmonized standards  
UNI EN 1865 - UNI EN 1789*

---

## MAIN FEATURES

---

Size	Adults
Usage	Transport
Lying surface	With Trendelenburg and Fowler
Height (cm)	16
Width (cm)	55
Length (cm)	196
Length with extended handles (cm)	233
Weight (kg)	20,8
Loading capacity (kg)	170
Wheel type	4 Small Fixed Wheels
10G Certification	
Material	Anodized aluminium HDPE (High-density polyethylene)

---

## IMAGES

---



---

## SEE ALSO

---



**Fixed stretcher 1510 PROOF**  
Fixed stretcher with nylon cover



**Titanus 7060/4RG PROOF**  
Certified stainless steel variable height trolley with four rotating wheels



**Titanus 7062/4RG PROOF**  
Stainless steel variable height trolley with four rotating wheels high version

---

## ACCESSORIES

---



**936/A**  
Phleboclysis stand for stretchers  
Art. 1510 Proof and Art. 1515 Proof

---

---

## STANDARD ACCESSORIES

---



**7014/A**  
4 pcs. Skay fire-proof electrowelded  
mattress



**608/A-MEB**  
2 pieces orange belt with metallic  
hook and MeBer band (L. 155 cm)



**605/C**  
Orange belt in one piece with  
plastic buckle mm 50 and ME.BER.  
ribbon for proof mattresses



**612/AN-2/MEB**  
Adjustable thoracic abdominal belt  
orange/black with MeBer band and  
4 points fastening for self loading  
stretchers and sedan chairs

---